

OWN THE
IMPOSSIBLE

DAMAC

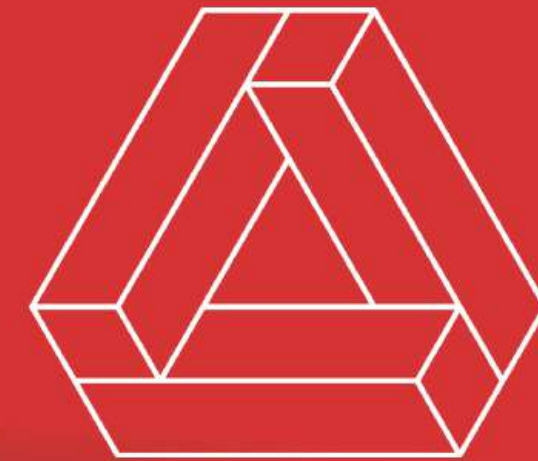

ZADA
BUSINESS BAY

#ZadaPossible



Z



Dubai Mall (7 Mins)



Shk. Zayed Road (4 Mins)



Business Bay Metro (4 Mins)



Al Khail Road (8 Mins)



Jumeirah / Kite Beach (15 Mins)



Mall of the Emirates (20 Mins)



Dubai International Airport (20 Mins)

WHY BUSINESS BAY?

~~IM~~POSSIBLE



Dubai's central business district (240+ Buildings)



Attractive to Investors and Home owners



High Occupancy and Rental Yields



893 units sold at 1.2 Billion Dhs. (Jan – May 2019)
62% of units sold are residential

#ZadaPossible

WHY ZADA?

~~IM~~POSSIBLE



Freehold
1 Bedrooms



Premium
location



Close to downtown
(World's largest mall)



Proximity to grade A
commercial / leisure lifestyle



Enabling works
started



Anticipated completion
Q4, 2022

#ZadaPossible

DAMAC

ZADA CONFIGURATION

IMPOSSIBLE



Basement

4 levels

Reception

Ground level

Podiums

3 levels

1 BR Apartments

26 floors

Elevators

7 (6 Passenger, 1 Service)

Covered Parking

1 per unit

Kitchen

Fitted with appliances

#ZadaPossible

DAMAC



#ZadaPossible

UNIT LAYOUT



DAMAC



#ZadaPossible

UNIT LAYOUT















DAMAC

THE ZADA OFFERING

~~IM~~POSSIBLE



#ZadaPossible

AVERAGE

1 BR Units: **483 Sqft**

Price/Sqft: **1,506**

Ticket Size: **742,385**

Service Charges: **AED 17 / Sqft**

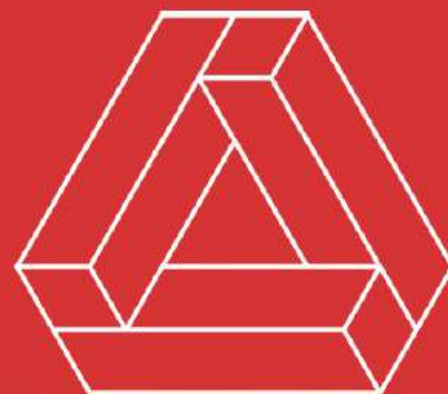

1-BR APARTMENTS

FROM

AED 6999,999

#ZadaPossible

INVESTMENT PLAN

~~IM~~POSSIBLE

PAY OVER FIVE YEARS

AED 6,999 MONTHLY

21%*

Down payment
*4% DLD extra

1%

Every month for
59 months

20%

Final payment
(60th month)

DAMAC

INVESTOR SCENARIO

~~IM~~POSSIBLE

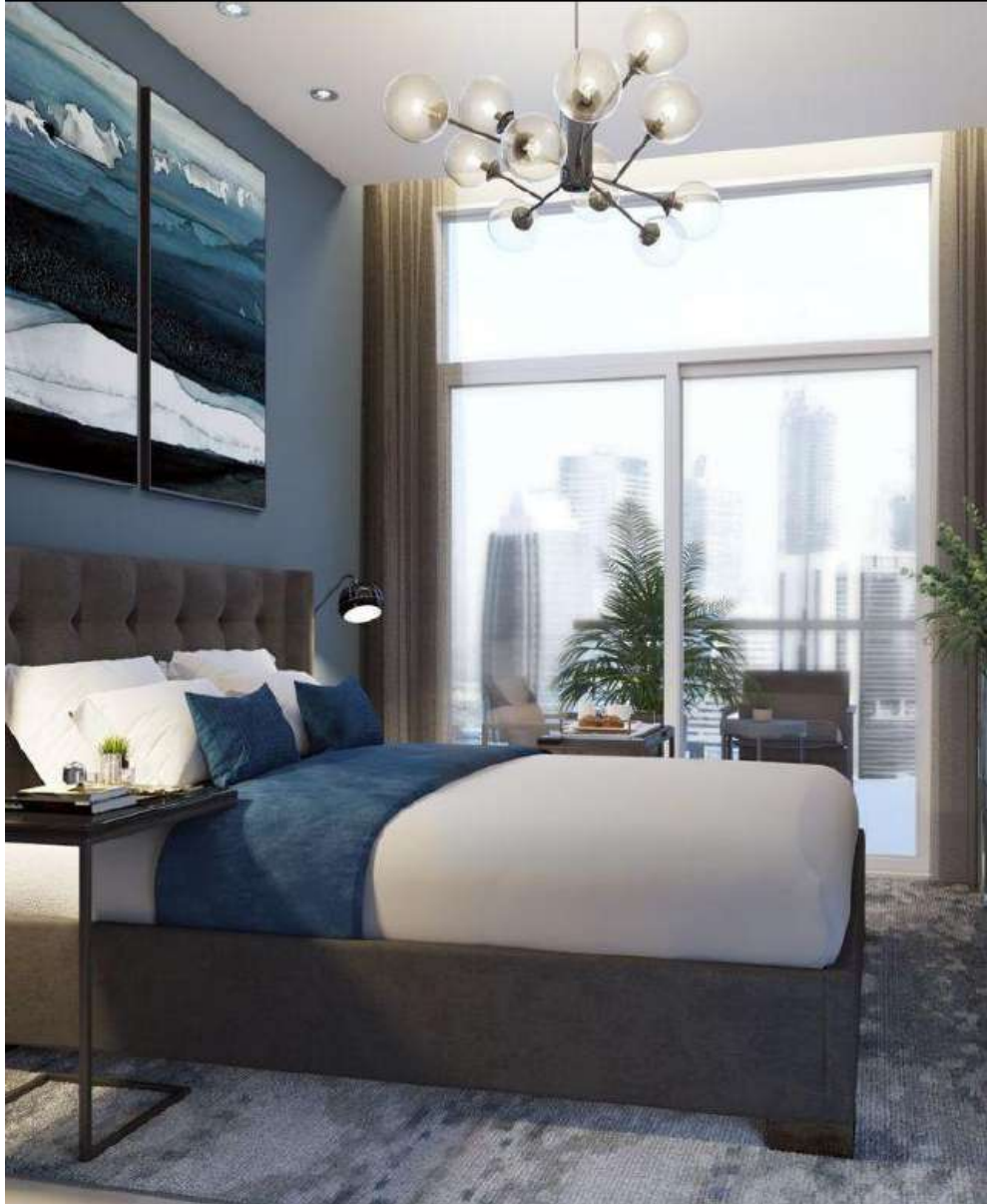

| | |
|--------------------------------------|-------------|
| Ticket size 1 Bedroom (Average) | 742,385 Dhs |
| 1 Bedroom size (Average) | 483 Sqft |
| Annual Rent* | 84,000 Dhs |
| Annual Service Charges (AED 17/Sqft) | 8,211 Dhs |
| Net Rental Yield | 75,789 Dhs |
| Anticipated annual ROI | 10.21% |

***Source:** Business Bay rental yield, Property Monitor, June 3rd, 2019

#ZadaPossible



DAMAC

END-USER SCENARIO

~~IM~~POSSIBLE

| | |
|--|-------------|
| Ticket size 1 Bedroom (Average) | 742,385 Dhs |
| Down Payment @ 21% | 155,900 Dhs |
| 1% monthly (42 months @ 7,424/month) | 311,808 Dhs |
| 37% Post completion | 274,677 Dhs |
| Mortgage for 35% approx. for 15 years* | 2,154 Dhs |
| Monthly rent for 1 Bedroom | 7,000 Dhs |

***Source:** Mortgage Finder calculated at 4% interest yearly

#ZadaPossible

NEXT STEPS?

~~IM~~POSSIBLE

COLLECT YOUR
EOIs

19/06 – 28/06

BOOKINGS OPEN ON 29/06 (10.00 AM ONWARDS)

ZADA BUSINESS BAY

DAMAC's exciting new opportunity launches

29.06.2019

10.00 am – 10.00 pm



FOUR SEASONS
JUMEIRAH

ZADA SUMMARY

~~IM~~POSSIBLE

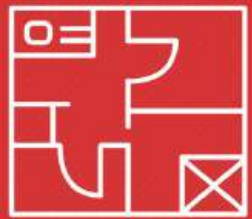

1 bedrooms with
spacious balconies



Close to quality work
and leisure lifestyle



High occupancy
and rental yield



Average price
for 1 bedroom at
744,675 Dhs.



21% + 4% DP
1% for 59 months
20% in 60th month



Anticipated handover
in Q4, 2022



SetRite
REALTORS

+91-98881-05000
www.setriterealtors.com